

The Buyers Guide

After making sure the products you wish to compare have the correct capacity for your needs:

1. Always look for the most efficient product by making sure the label's colour band is the darkest green.
2. Buying an A++ class product will typically reduce operational costs by 50% or more compared to an 'A' rated appliance.
3. If you are buying new electrical appliances, retailers are obliged by law to either accept return of your old appliances in store free of charge or tell you where you can take them for (free) recycling.
4. Many retailers offer collection of old appliances from your home, although they are not obliged to do this.

For additional information about the EU energy label: www.direct.gov.uk/energylabel



Further Information

For information on how to reduce your energy bills at home: www.est.org.uk

If you are interested in learning more about how energy labelling of household appliances works in the EU and selected individual countries, this is the website to visit! www.come-on-labels.eu



Other Useful Labels



Energy Saving Trust Recommended

This logo can only be used on the most energy efficient products, and includes TVs, boilers, glazing and insulation.



European EcoLabel

This label indicates that the product has been independently assessed and found to meet strict environmental criteria (considering more than just energy consumption), putting it among the best in its class.



Energy Star

This label is only used on office equipment and shows that the product has achieved energy efficiency standards set by the EU.



The sole responsibility for the content of this publication lies with the authors. It does not necessarily reflect the opinion of the European Communities. The European Commission is not responsible for any use that may be made of the information contained therein.

The new EU Energy label

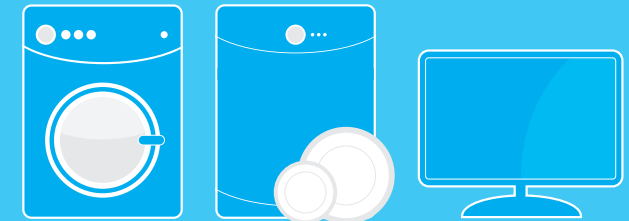

What it all means!



SevernWye
ENERGY AGENCY

The Label...

As of December 2011 the EU Energy Label will change. The new label has been designed to give consumers a better understanding of the product's energy performance.

The label shows the total energy consumption, along with additional information relevant to that product - such as the volume of storage compartments for refrigerators or noise levels for dishwashers.

Those products in the darkest green category will be the most energy efficient.

Old Label...

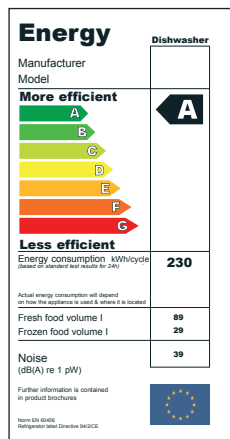

New Label...



For additional information about the EU energy label: www.direct.gov.uk/energylabel

Your guide to the symbols...

150 kWh/annum

Annual energy consumption based on standard test results for 24 hours.



Noise emissions in decibels



Sum of storage volume in litres of all frozen food storage compartments



Sum of storage volume in litres of all storage compartments without a star rating



Capacity in litres in standard place settings



Drying efficiency class



Annual water consumption in litres, based on 280 standard dishwashing cycles



Noise emissions in decibels during the washing and spinning phases, for the standard 60° cotton programme at full load



Spin drying efficiency class



Rated capacity in kg for the standard 60° or 40° cotton programme at full load



Annual water consumption in litres, based on 220 standard clothes washing cycles

Also of use...

Many household appliances already carry the label and it is expected that more products will be included in future years.

From December 2011

Refrigerating appliances

Washing machines

Tumble dryers

Washer-dryers

Dishwashers

Light bulbs

Televisions

Future

Vacuum cleaners

Boilers

All washing machines with a rated capacity greater than 3kg, must have an A class washing performance. This means these machines will no longer have this performance indicated on the new label.

All dishwashers must have an A class cleaning performance and as such this is no longer indicated on the new label.

All refrigerators must now have an energy class of at least A.

